

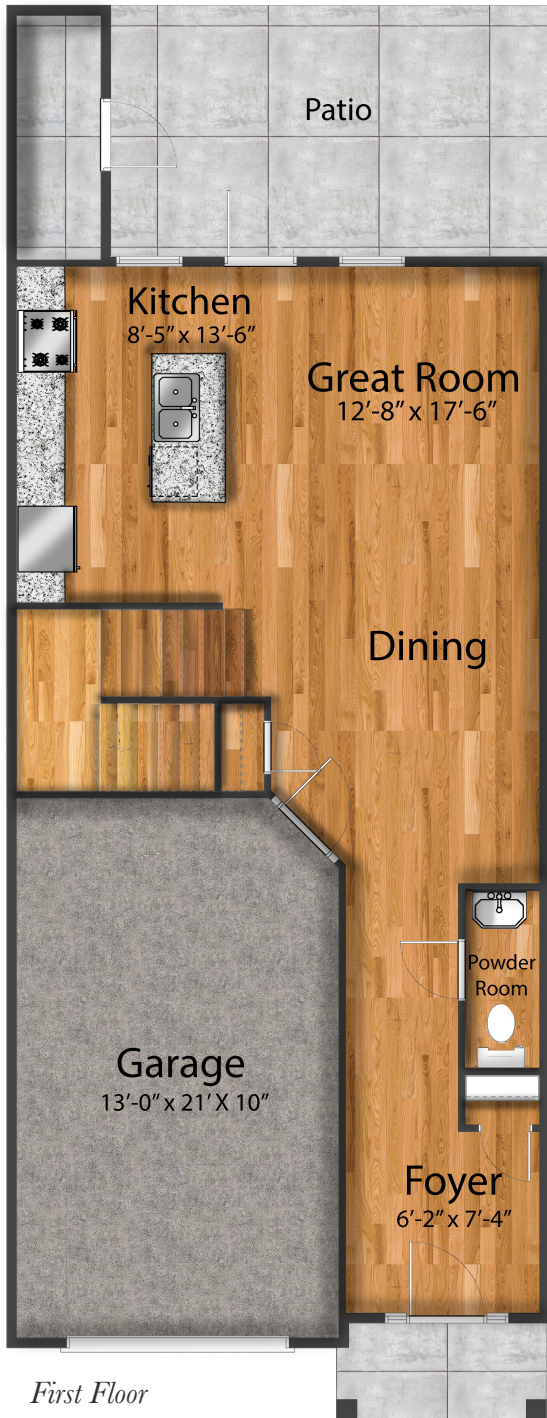

CAMDEN

3 Bedrooms | 2.5 Baths | Garage
1,550 SF



CAMDEN

INCLUDED FEATURES

INTERIOR FINISHES:

- Open Floor Plan with 9' Ceilings on the First Floor
- Tray Ceiling in Owner's Bedroom
- Sherwin Williams Wall Paint (3) Designer Color Choices with Semi Gloss "White" Trim and Doors
- LED Flush Mount Recessed Ceiling Lights in the Foyer, Great Room, Kitchen, Hall and Stairs
- Two Pendant Lights over Island
- 52" Ceiling Fan with Light Fixture in the Great Room
- Progress Lighting™ Light Fixtures

CUSTOM TRIM FINISHES:

- Base Molding: 1 x 6 Pre-Primed Pine
- Door Casing: 1 x 4 Pre-Painted Pine with 5/4 Header & Accent
- Interior Doors: Jeld Wen Santa Fe Two Panel

KITCHEN:

- KCD, The Premier Series, Birchwood with Full Overlay
 - ◇ 42" High Shaker Cabinets
 - ◇ Crown Molding
 - ◇ Soft Close Doors and Drawers
 - ◇ Decorative Handles
- Island Bar with Custom Trim and Overhang
- Color Choices:
 - ◇ Brooklyn Bright White | Brooklyn Modern Gray | Shaker Designer White | Shaker Espresso | Napa White
- Granite Countertops
- Built-In Pantry Cabinet with Pullouts
- Under-Counter Deep Single Bowl Stainless Steel Sink
- Moen® Single Handle Stainless Steel Faucet with Pullout Sprayer

FRIGIDAIRE® STAINLESS STEEL APPLIANCES:

- Side-by-Side Refrigerator
- Smooth Top Range
- Dishwasher
- Built-in Microwave

OWNER'S BATH:

- KCD, The Premier Series, Birchwood with Full Overlay
- Shaker Espresso Vanity with Soft Close Doors and Drawers with Two Sinks
- Custom Ceramic Tile Shower with Custom Frameless Clear Glass Enclosure
 - ◇ Floridatile, Ainslee Park Color Calacatta—white and gray marble look
 - ◇ 12" x 24" Tile Shower Walls to Ceiling, Bricklay
 - ◇ 2" x 2" Mosaic Shower Floor
 - ◇ 1 Corner Shelf and 1 Corner Seat
 - ◇ 12" x 24" Bath Room Floor, Bricklay
- Moen® "Eva" Brush Nickel, 8" spread Faucets, Showerhead, Handheld Shower Slider Bar and Accessories
- Pure White Cultured Marble Countertops with Integrated Wave Bowl Sinks
- Plate Glass Mirror
- Comfort Height Elongated Toilet

HALL BATH:

- KCD, The Premier Series, Birchwood with Full Overlay
- Shaker Espresso Vanity with Soft Close Doors and Drawers
- Tub Shower Surround in Hall Bath
- Moen "Eva" Brush Nickel, Faucets and Accessories
- Ceramic Tile Floor
 - ◇ Floridatile, Craftsman or Westmont 12" x 12"
- Pure White Cultured Marble Countertops with Integrated Wave Bowl Sink
- Plate Glass Mirror
- Elongated Toilet

POWDER ROOM:

- White Pedestal Sink
- Moen® "Eva" Brush Nickel, Faucets and Accessories
- Framed Mirror
- Elongated Toilet

LAUNDRY ROOM:

- Ceramic Tile Floor
 - ◇ Floridatile, Craftsman or Westmont 12" x 12"

FLOORING:

- Foyer, Great Room, Kitchen, Dining, Powder Room and Staircase Landing
 - ◇ SAR Floors Titan Collection LVT Plank Flooring
 - ◇ LVT Hardwood 7" x 48" Plank Flooring
 - ◇ Waterproof, AmourGuard™, Tri-Core ESPC™, QuiteStep Cushion™ and Pet Friendly
- Owner's Bedroom, 2nd Bedroom, 3rd Bedroom and Upstairs Hall
 - ◇ Mohawk Carpet—Portico Collection, Calming Option
 - ◇ SmartStrand FOREVER CLEAN Unique built-in stain and soil protection that won't wear or wash off

STAIRS AND RAILINGS:

- The Treads and Oak Handrails will be Stained to coordinate with the Floor
- The Risers and Stringers will be painted White
- The Balusters are Satin Black Iron

HVAC:

- Goodman Natural Gas Furnace
- Goodman High Efficiency Central Air
- Electronic Zoning System
- Programmable Thermostats

INSULATION:

- R-15 Batt Fiberglass Insulation in Walls
- R-10 Slab
- R-38 Blown-In Fiberglass Insulation in Ceiling

GARAGE:

- Steel Insulated Garage Door with Decorative Windows and Black Hardware
- Drywall, Finished and Painted Interior
- Garage Door Opener
- Exterior Key Pad
- GFI Electrical Outlet

ADDITIONAL FEATURES:

- Prewired for Security System
- Ventilated Vinyl Coated White Shelving in Closets & Linen
- Structured Wiring with CAT5 & RG6
- Circuit Breaker Panel 200 amp
- Exterior Hose Bibs
- Exterior Weather Protected Electrical Outlets
- 50 Gallon Electric Water Heater
- Two Driveway Parking Spaces
- Professionally Designed Landscape Package and Bermuda Sod

Patios and Storage Unit configurations and sizes may vary on all Exterior and Interior Units. Due to field conditions, rolling and/or sloping lots, some units may have wood decks in lieu of patios.

Prices, specification, including features and available options are subject to change at any time without notice.